

## ◆ GS-T2-DC PRODUCT-DETAILS

1. Meets Class II (8/20 $\mu$ s waveform) SPD tests
2. Based on zinc oxide technology
3. Using 34S MOV, the maximum will be up to 8/20 $\mu$ s 40ka
4. No power frequency continuous flow
5. The operating environment temperature is -40°C~+70°C
6. Remote signaling function is optional.
7. When product fails, the green window turns to red and remote signaling provides remote alarm function.



### Technical Data

Pole	2P
SPD Type	Type 2/ClassII
Technology	MOV
Protection mode(s)	DC+PE,DC~
Max.continuous operating voltage (D.c.)[Ucpv]	600V
Nominal discharge current(8/20 $\mu$ s)[In]	20kA
Max.discharge current (8/20 $\mu$ s)[Imax]	40kA
Protection level[Up]	$\leq 2.5$ kV
Response time[tA]	$\leq 25$ ns
Admissible short-circuit current[Isccr]	25kA
Max.backup fuse	63A gL/Gg

### Mechanical Data

SPD system	DC system
Plugable	Available
Installation	35mm DIN rail
Enclosure material	Thermoplastic,UL 94 V-O
Operating temperature	-40°C... +80°C
Protection rating	IP20
Operating state /fault indication	Green/Red
Remote Signaling	Optional
Wiring for remote signaling	Max 1.5mm solid/flexible
Max. Voltage/Current for remote signaling	250V/0.1A;125V/0.2A;75V/0.5A
standardization	IEC 61643-11/EN 61643-11
Certification	CE,CB,RoHS,TUV

### Size

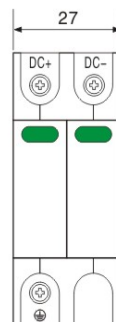
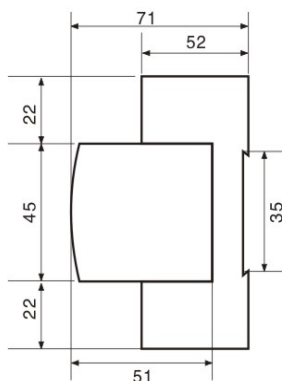

2P

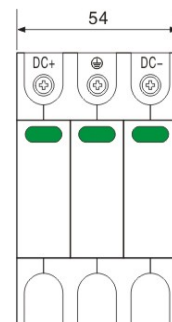

3P